

# Special tools "U" shape forming pliers

## PPR 5000D



**PPR 5000D:** It forms the component wire in a U shape  
A=7.62

ESD-safe handles.  
技术咨询与报价  
电话: 18823303057 QQ:2104028976

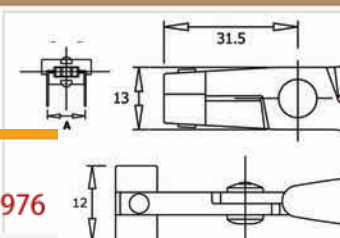

Order code	Length (mm)	Cutting force (kg)	Copper wire (Ø mm)	Copper wire (awg)
PPR 5000D	150	3	0.6-0.8	22-20

## PPR 5001D



**PPR 5001D:** It forms the component wire in a U shape  
A=10.16

ESD-safe handles.

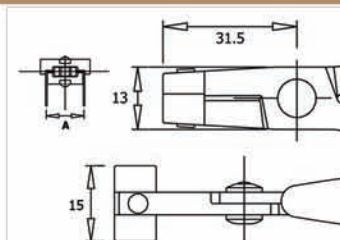

Order code	Length (mm)	Cutting force (kg)	Copper wire (Ø mm)	Copper wire (awg)
PPR 5001D	150	3	0.6-0.8	22-20

## PPR 5002D



**PPR 5002D:** It forms the component wire in a U shape  
A=12.70

ESD-safe handles.

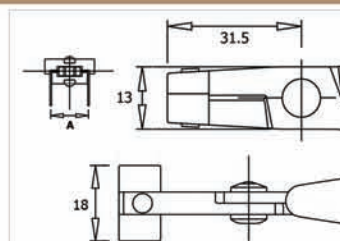

Order code	Length (mm)	Cutting force (kg)	Copper wire (Ø mm)	Copper wire (awg)
PPR 5002D	150	3	0.6-0.8	22-20

## PPR 5003D



**PPR 5003D:** It forms the component wire in a U shape  
A=15.24

ESD-safe handles.

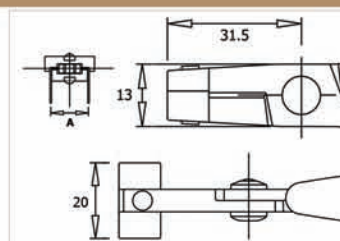

Order code	Length (mm)	Cutting force (kg)	Copper wire (Ø mm)	Copper wire (awg)
PPR 5003D	150	3	0.6-0.8	22-20

# Special tools "90°" forming pliers

## PN 5040/90D



**PN 5040/90D:** Special pliers which cuts and forms the component wire at 90° in one step. It is possible to adjust the length by means of a sliding stop. Steel thickness 5.0mm. Tool length 158mm.

ESD-safe handles.

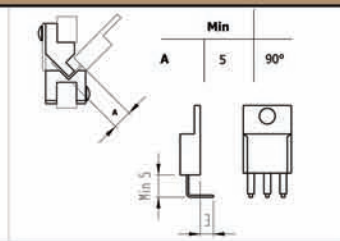

Order code	Length (mm)	Cutting force (kg)	Copper wire (Ø mm)	Copper wire (awg)
PN 5040/90D	158	3	1.30	16

## PN 5040/7D



**PN 5040/7D:** Special pliers which forms the component wire at 90°. With adjustable stop to adjust the forming distance (A). Max forming width 16mm to allow TO220 and TO247 forming components. This item combines both PN5040 and PN5040/5 articles. Steel thickness 5.0mm. Tool length 158mm. ESD-safe handles.

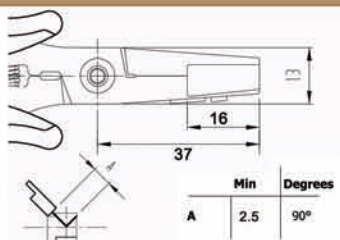

Order code	Length (mm)	Cutting force (kg)	Copper wire (Ø mm)	Copper wire (awg)
PN 5040/7D	158	3	1.30	16



special tools